

LOW Series

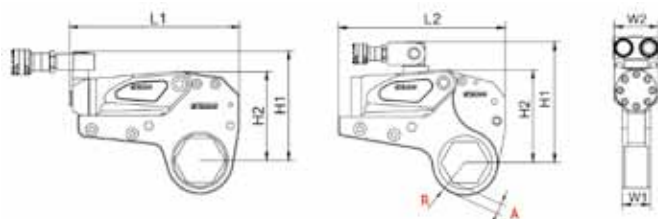

Product Description

- Low series is the professional hydraulic torque wrench which vigorously extends in international market. Compare with the square drive hydraulic torque wrench, this series work directly on the nuts and its body suits well in the narrow space. Low series covers the nuts from M19-M175 to fulfill all different working situations. The user can just replace the hexagon cassette or add the reducer.

Specifications

- 700 bar maximum working pressure, Repeat Accuracy $\pm 3\%$
- 5 different model from 232~44593 N.m
- $360^\circ \times 180^\circ$ swivel & $360^\circ \times 360^\circ$ swivel allow the wrench easy to operation and with no space limitation.
- More accuracy and easier operate on the nuts.
- Compact design with longer arm fully advances the reliability.
- High resistance with Aluminum-Titanium Alloy and light body

Ordering Information

Model No.	Torque (N. m)	Nut size(mm)	Power head N.W (kg)	Work head N.W (kg)	L1(mm)	L2(mm)	H1(mm)	H2(mm)	W1 (mm)	W2 (mm)
2LOW	232~2328	19~55	1	1.6	195.4	186	125.9	102.3	32	51
	241~2414	60	1	1.7	195.4	186	128.5	105	32	51
4LOW	585~2510	34~36	2	4.4	261.6	245	177	135.7	42	66
	585~5021	41	2	4.4	261.6	245	177	135.7	42	66
	585~5858	46~65	2	4.6	261.6	245	187	145.7	42	66
	647~6474	70~80	2	4.6	261.6	245	187	145.7	42	66
8LOW	1049~10491	41~95	3.3	8	304	300	207	169	53	83
	1177~11774	100~105	3.3	8.4	304	300	216	178	53	83
14LOW	1852~18521	50~117	5.5	11.6	361	361	239	204	64	99
30LOW	4188~41882	110~155	11.4	29	441	430	303	272	85	131
	4459~44593	160~175	11.4	30	441	430	315	285	85	131

Series Hexagon Cassette Selection Chart

2LOW				4LOW				8LOW			
Type	R(mm)	A(mm)	Max Torque (N.m)	Type	R(mm)	A(mm)	Max Torque (N.m)	Type	R(mm)	A(mm)	Max Torque (N.m)
2LOW-19	27	16	2328	4LOW-34	36	16	2510	8LOW-41	46	22	10941
2LOW-22	27	14	2328	4LOW-36	36	15	2510	8LOW-46	46	19	10941
2LOW-27	27	11	2328	4LOW-41	39	15	5021	8LOW-50	46	17	10941
2LOW-30	29	12	2328	4LOW-46	42	15	5858	8LOW-55	50	18	10941
2LOW-32	29	11	2328	4LOW-50	44	15	5858	8LOW-60	52	17	10941
2LOW-34	31	11	2328	4LOW-55	46	14	5858	8LOW-65	55	17	10941
2LOW-36	31	10	2328	4LOW-60	50	15	5858	8LOW-70	58	17	10941
2LOW-41	34	10	2328	4LOW-65	53	15	5858	8LOW-75	60	17	10941
2LOW-46	37	10	2328	4LOW-70	56	15	6474	8LOW-80	63	16	10941
2LOW-50	40	11	2328	4LOW-75	59	15	6474	8LOW-85	66	16	10941
2LOW-55	43	11	2328	4LOW-80	61	15	6474	8LOW-90	69	17	10941
2LOW-60	46	11	2414					8LOW-95	71	16	10941
								8LOW-100	75	17	11774
								8LOW-105	78	17	11774

14LOW				30LOW			
Type	R(mm)	A(mm)	Max Torque(N.m)	Type	R(mm)	A(mm)	Max Torque(N.m)
14LOW-50	60	31	18521	30LOW-85	78	28	41882
14LOW-55	60	28	18521	30LOW-90	78	27	41882
14LOW-60	60	25	18521	30LOW-95	83	28	41882
14LOW-65	60	22	18521	30LOW-100	83	25	41882
14LOW-70	60	19	18521	30LOW-105	89	28	41882
14LOW-75	63	19	18521	30LOW-110	89	25	41882
14LOW-80	66	19	18521	30LOW-115	95	28	41882
14LOW-85	69	19	18521	30LOW-117	95	27	41882
14LOW-90	72	20	18521	30LOW-120	95	25	41882
14LOW-95	74	19	18521	30LOW-125	101	29	41882
14LOW-100	77	19	18521	30LOW-130	101	26	41882
14LOW-105	80	19	18521	30LOW-135	104	26	41882
14LOW-110	83	19	18521	30LOW-140	110	29	41882
14LOW-115	87	20	18521	30LOW-145	110	26	41882
14LOW-117	87	19	18521	30LOW-150	116	29	41882
				30LOW-155	116	26	41882
				30LOW-160	128	36	44593
				30LOW-165	128	33	44593
				30LOW-170	128	30	44593
				30LOW-175	128	27	44593

H Series

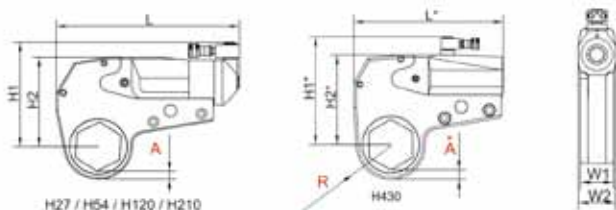

Product Description

- H series is the professional hydraulic torque wrench which vigorously extends in international market. H low profile torque wrenches designed for accessing limited areas and serves good solutions with numbers of replaceable cassettes and adaptors.
- Drivers can be replaced easily and fast without using any tools.
- Saves time by means of easy replacement of attachments.
- Light weight Aluminum-Titanium Alloy design allows easy operation even in rough conditions.

Specifications

- 700 bar maximum working pressure, Repeat Accuracy $\pm 3\%$
- 5 different model from 2625~48481 N.m
- Fitted with 360°x360° Uni-Swivel quick release couplings
- Low profile design to accessing limited areas
- Drivers and adaptors can be replaced easily

Ordering Information

Model No.	Torque (N.m)	Screw sizes(mm)	work head N.W (kg)	L(mm)	H1(mm)	H2(mm)	W1(mm)	W2(mm)	A(mm)
H27	262~2625	19~46	0.9	193	125	97	32	51	10~15
	306~3068	50~60	0.9	193	136	108	32	51	10~11
H54	537~5372	27~65	1.9	250	158	125	41	64	11~19
	603~6037	70~80	1.9	250	169	136	41	64	11.7~12
H120	1173~11737	50~80	3.4	310	189	157	52	78	15~15.2
	1434~14349	85~105	3.4	310	214	182	52	78	16~22
H210	2121~21216	70~100	5.9	378	223	191	64	97	8~21
	2312~23124	105~115	5.9	378	236	204	64	97	18~24
H430	4379~43792	80~117	16.1	405	291	242	83	93	25~31
	4848~48481	120~175	16.1	405	309	260	83	93	25~34

Series Hexagon Cassette Selection Chart

H27				H54				H120			
Type	R(mm)	A(mm)	Max Torque (N.m)	Type	R(mm)	A(mm)	Max Torque (N.m)	Type	R(mm)	A(mm)	Max Torque (N.m)
H27-19	26	15	2625	H54-27	36	19	5372	H120-50	44	15	11737
H27-22	26	14	2625	H54-30	35	17	5372	H120-55	47	15	11737
H27-27	26	11	2625	H54-32	35	16	5372	H120-60	50	15	11737
H27-30	28	11	2625	H54-34	35	16	5372	H120-65	53	15	11737
H27-32	28	10	2625	H54-36	35	14	5372	H120-70	56	15	11737
H27-34	31	11	2328	H54-41	35	11	5372	H120-75	58	15	11737
H27-36	31	10	2625	H54-46	37	11	5858	H120-80	61	15	11737
H27-41	34	10	2625	H54-50	41	12	5372	H120-85	66	16	14349
H27-46	37	10	2625	H54-55	44	13	5372	H120-90	69	16	14349
H27-50	40	11	3068	H54-60	47	12	5372	H120-95	71	16	14349
H27-55	42	11	3068	H54-65	50	12	5372	H120-100	77	22	14349
H27-60	50	10	3068	H54-70	52	12	6037	H120-105	77	19	14349
				H54-75	56	12	6037				
				H54-80	58	12	6037				

H210				H430			
Type	R(mm)	A(mm)	Max Torque(N.m)	Type	R(mm)	A(mm)	Max Torque(N.m)
H210-70	59	18	21216	H430-80	72	25	43792
H210-75	62	18	21216	H430-85	78	28	43792
H210-80	65	18	21216	H430-90	78	25	43792
H210-85	68	21	21216	H430-95	84	28	43792
H210-90	71	18	21216	H430-100	84	26	43792
H210-95	77	21	21216	H430-105	90	28	43792
H210-100	77	18	21216	H430-110	94	31	43792
H210-105	79	18	23214	H430-115	94	28	43792
H210-110	87	24	23124	H430-117	94	28	43792
H210-115	87	21	23124	H430-120	101	31	48481
				H430-125	101	28	48481
				H430-130	101	25	48481
				H430-135	105	26	48481
				H430-140	110	29	48481
				H430-145	110	26	48481
				H430-150	115	29	48481
				H430-155	115	26	48481
				H430-160	121	29	48481
				H430-165	121	26	48481
				H430-170	128	30	48481
				H430-175	128	27	48481

IBT Series

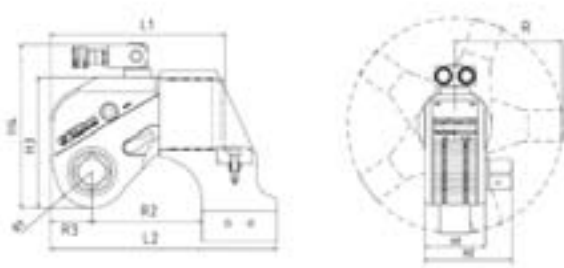

Product Description

- IBT series is the professional hydraulic torque wrench which vigorously extends in international market.
- It's raw material is Aluminum-Titanium Alloy which makes the wrench light and high intense.
- IBT series has 10 models with the range from 112N. m to 72000N. m, covers the most of bolts size, and be the most comprehensive available in the market.

Specifications

- 700 bar maximum working pressure, Repeat Accuracy $\pm 3\%$
- The $360^\circ \times 180^\circ$ swivel is free to operation with no space limitation.
- The square drive operate with the high intense socket and suitable with large range of bolts.
- 360° adjustable reaction arm allows placing in any support point.
- Compact design with the raw material of advanced Aluminum-Titanium Alloy, high intense.
- The new locking coupler ensures smooth oil flow.

Ordering Information

Model No.	07IBT	1IBT	3IBT	5IBT	8IBT	10IBT	20IBT	25IBT	35IBT	50IBT
Torque (N. M)	112~1120	183~1837	451~4512	752~7528	1078~10780	1551~15516	2666~26664	3472~34725	4866~48666	7200~72000
Bolt Size(mm)	14~30	16~36	22~48	27~56	30~64	36~72	42~90	48~100	64~120	72~125
N.W(kg)	1.8	2.5	5	8	11	15	26.5	35	50	87
L1	110.8	144.5	178	210.5	222	245.5	307.5	323	372.5	400
L2	139.3	173.5	229	270.5	293	317.5	383.5	401	496.5	516
H1	42	50	68	80	90	100	120	137	153	160
H2	65.8	72	95	123	134	142	183	200	216	223
H3	76.2	96	127	149	167	182	220	247	282	291
H4	108.1	131	176.5	199	217	232	270	297	332	341
R	75	91.5	123.5	140	165	178	213	228	243.5	258
R1	20.5	26	34	39	47	51	59	66	77	81
R2	68.3	85	114	137	153	154	186	199	241	259
R3	25	29	40	46.5	47	58.5	71	66	79	97.5
Square drive	3/4"	3/4"	1"	1-1/2"	1-1/2"	1-1/2"	2-1/2"	2-1/2"	2-1/2"	2-1/2"

S Series

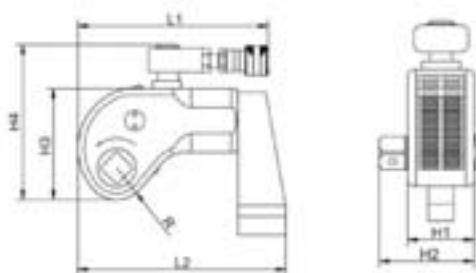

Product Description

- S series hydraulic torque wrench configured with high technology, with Aluminum-Titanium Alloy, ideal for long-term usage. With calibration service and support, S series hydraulic torque wrench can accomplish big missions efficiently.
- Almost every tightening & loosening problems can be accomplished with this series with MAX torque capacity up to 36992 N.m
- A wide range of accessory for S series is available with us.

Specifications

- 700 bar maximum working pressure, Repeat Accuracy $\pm 3\%$
- 5 different models from 1727~36992N. m
- 360° multi-positional swivel quick release couplings
- Working with the high resistance sockets, suitable for Various sizes.
- 360° Adjustable reaction arm with safety lock, can be used without reaction arm
- High resistance with light Aluminum-Titanium Alloy and light body
- Replaceable square drive adapters

Ordering Information

Model No.	Torque (N.m)	"Bolt size (M)"	Square Drive Inches	N.W(kg)	L1(mm)	L2(mm)	H1(mm)	H2(mm)	H3(mm)	H4(mm)	R(mm)
S17	172~1727	16~36	3/4"	2	129	167	51	73	90	131	25
S45	452~4529	22~48	1"	4.6	167	218	68	98	121	170	34
S100	1006~10064	30~64	1 1/2"	10	223	293	92	135	163	211	46
S150	1497~14974	36~72	1 1/2"	14.8	264	323	100	141	177	225	50
S370	3699~36992	48~100	2 1/2"	32.5	329	432	137	104	240	288	66

LOW/H Reducer Insert

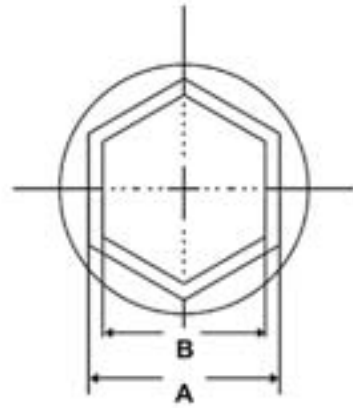

Imperial and non-standard Reducer Inserts are available

Ordering Information

Wrench Model	Cassette	Nut Size(S)	Reducer type						"The locking ring type"
			Type	A/B(mm)	Type	A/B(mm)	Type	A/B(mm)	
2LOW	2LOW-50	50	2G5041	50/41	2G5036	50/36	2G5032	50/32	H-50
	2LOW-46	46	2G4636	46/36	2G4632	46/32	2G4630	46/30	H-46
	2LOW-41	41	2G4132	41/32	2G4130	41/30	2G4127	41/27	H-41
	2LOW-36	36	2G3630	36/30	2G3627	36/27			H-36
	2LOW-32	32	2G3227	32/27					H-32
	2LOW-30	30							
	2LOW-27	27							
4LOW	4LOW-65	65	4G6555	65/55	4G6550	65/50	4G6546	65/46	H-56
	4LOW-60	60	4G6050	60/50	4G6046	60/46	4G6041	60/41	H-60
	4LOW-55	55	4G5546	55/46	4G5541	55/41	4G5536	55/36	H-55
	4LOW-50	50	4G5041	50/41	4G5036	50/36	4G5032	50/32	H-50
	4LOW-46	46	4G4636	46/36	4G4632	46/32	4G4630	46/30	H-46
	4LOW-41	41	4G4132	41/32	4G4130	41/30	4G4127	41/27	H-41
	4LOW-36	36	4G3630	36/30	4G3627	36/27			H-36
	4LOW-32	32	4G3227	32/27					H-32
	4LOW-30	30							
	4LOW-27	27							

Hydraulic Torque Wrench and Tools

Ordering Information

Wrench Model	Cassette	Nut Size(S)	Reducer type						"The locking ring type"
			Type	A/B(mm)	Type	A/B(mm)	Type	A/B(mm)	
8LOW	8LOW-90	90	8G9080	90/80	8G9075	90/75	8G9070	90/70	H-90
	8LOW-85	85	8G8575	85/75	8G8570	85/70	8G8565	85/65	H-85
	8LOW-80	80	8G8070	80/70	8G8065	80/65	8G8060	80/60	H-80
	8LOW-75	75	8G7565	75/65	8G7560	75/60	8G7555	75/55	H-75
	8LOW-70	70	8G7060	70/60	8G7055	70/55	8G7050	70/50	H-70
	8LOW-65	65	8G6555	65/55	8G6550	65/50	8G6545	65/45	H-65
	8LOW-60	60	8G6050	60/50	8G6046	60/46			H-60
	8LOW-55	55	8G5546	55/46	8G5541	55/41			H-55
	8LOW-50	50							
14LOW	14LOW-115	115	14G115105	115/105	14G115100	115/100	14G11595	115/95	H-115
	14LOW-110	110	14G110100	110/100	14G11095	110/95	14G11090	110/90	H-110
	14LOW-105	105	14G10595	105/95	14G10590	105/90	14G10585	105/85	H-105
	14LOW-100	100	14G10090	100/90	14G10085	100/85	14G10080	100/80	H-100
	14LOW-95	95	14G9585	95/85	14G9580	95/80	14G9575	95/75	H-95
	14LOW-90	90	14G9080	90/80	14G9075	90/75	14G9070	90/70	H-90
	14LOW-85	85	14G8575	85/75	14G8570	85/70	14G8565	85/65	H-85
	14LOW-80	80	14G8070	80/70	14G8065	80/65			H-80
	14LOW-75	75	14G7565	75/65					H-75
	14LOW-70	70							
	14LOW-65	65							
30LOW	30LOW-155	155	30G155145	155/145	30G155130	155/130	30G155120	155/120	H-155
	30LOW-145	145	30G145130	145/130	30G145120	145/120	30G145115	145/115	H-145
	30LOW-130	130	30G130120	130/120	30G130115	130/115	30G130110	130/110	H-130
	30LOW-120	120	30G120110	120/110	30G120105	120/105	30G120100	120/100	H-120
	30LOW-115	115	30G115105	115/105	30G115100	115/100	30G11595	115/95	H-115
	30LOW-110	110	30G110100	110/100	30G11095	110/95	30G11090	110/90	H-110
	30LOW-105	105	30G10595	105/95	30G10590	105/90	30G10590	105/90	H-105
	30LOW-100	100	30G10090	100/90	30G10085	100/85	30G10080	100/80	H-100
	30LOW-95	95	30G9585	95/85	30G95080	95/80			H-95
	30LOW-90	90	30G9080	90/80					H-90
	30LOW-85	85							
	30LOW-80	80							

IBT/S Series Sockets



British and non-standard sockets can be customized

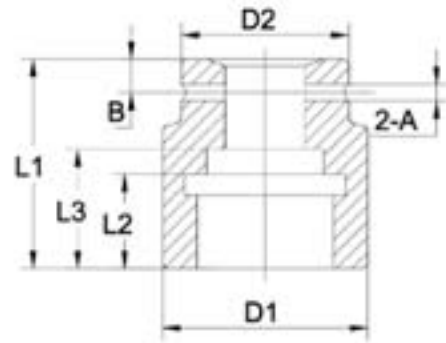

(mm)

Ordering Information

Bolt Type	3/4" 07IBT/1IBT								1" 3IBT								1-1/2" 5, 8, 10IBT								2-1/2" 20, 25, 35, 50IBT							
	D	N	A	B	L1	L2	L3	D1	D2	A	B	L1	L2	L3	D1	D2	A	B	L1	L2	L3	D1	D2	A	B	L1	L2	L3	D1	D2		
M16	24	6.3	10	54	32	32	40	40																								
M18	27	6.3	10	54	32	32	42	42																								
M20	30	6.3	10	54	33	33	46	44	8	14	59	32	32	54	54																	
M22	34	6.3	10	54	33	33	52	44	8	14	59	32	32	58	58																	
M24	36	6.3	10	57	33	33	54	44	8	14	62	32	32	59	59	8	16	85	44	44	74	74										
M27	41	6.3	10	58	33	33	60	44	8	14	65	38	38	67	54	8	16	85	44	44	74	74										
M30	46	6.3	10	63	38	38	66	44	8	14	65	38	38	74	54	8	16	85	44	44	74	74										
M33	50	6.3	10	65	40	40	71	44	8	14	70	43	43	79	60	8	16	90	45	45	79	79										
M36	55	6.3	10	70	45	45	77	54	8	14	80	42	52	84	60	8	16	90	45	45	84	84	8	18	100	57	57	86	114			
M39	60								8	14	85	45	57	89	60	8	16	100	45	57	94	75	8	18	100	52	52	119	119			
M42	65								8	14	85	45	57	98	70	8	16	100	45	57	98	80	8	18	100	52	52	119	119			
M45	70								8	14	90	50	62	104	70	8	16	105	50	62	104	80	8	18	120	67	67	128	128			
M48	75								8	14	95	50	65	108	70	8	16	110	50	65	118	90	8	18	120	67	67	128	128			
M52	80															8	16	115	55	72	118	90	8	18	130	71	71	128	128			
M56	85															8	16	125	60	77	128	90	8	18	130	71	71	129	129			
M60	90															8	16	125	60	77	139	90	8	18	140	61	73	139	139			
M64	95															8	16	130	65	82	139	90	8	18	140	66	73	139	139			
M68	100															8	16	135	70	87	144	90	8	18	140	71	81	148	130			
M72	105															8	16	135	70	87	149	90	8	18	150	77	89	156	130			
M76	110															8	16	135	70	87	158	90	8	18	150	72	90	158	130			
M80	115															8	16	135	70	87	159	95	8	18	150	82	98	168	130			
M85	120															8	16	135	70	87	168	95	8	18	150	82	98	178	130			
M90	130															8	16	155	93	105	189	95	8	18	170	93	114	189	130			
M95	135																						8	18	170	93	114	198	130			
M100	145																						8	18	170	98	122	210	152			
M105	150																						8	18	190	100	140	216	152			
M110	155																						8	18	190	100	140	229	152			
M115	165																						8	18	190	100	140	241	152			

The Choosing Of Hydraulic Torque Wrench

Strength Grade		4.8		6.8		8.8		10.9		12.9	
Min Breaking Strength		392Mpa		588Mpa		784Mpa		941Mpa		1176Mpa	
Material		Q325(SS41)		35(S35C)		35CrMo(SCM3)		42CrMo(SCM4)		40GrNiMoA(SNCM)	
Bolt	Diameter	Torque		Torque		Torque		Torque		Torque	
M (mm)	S(mm)	KGM	N. m	KGM	N. m	KGM	N. m	KGM	N. m	KGM	N. m
14	22	7	69	10	98	14	137	17	165	23	225
16	24	10	98	14	137	21	206	25	247	36	363
18	27	14	137	21	206	39	284	35	341	49	480
20	30	18	176	28	296	41	402	58	569	69	680
22	32	23	225	34	333	55	539	78	765	93	911
24	36	32	314	48	470	70	686	100	981	120	1176
27	41	45	441	65	637	105	1029	150	1472	180	1764
30	46	60	588	90	882	125	1225	200	1962	240	2352
33	50	75	735	115	1127	150	1470	210	2060	250	2450
36	55	100	980	150	1470	180	1764	250	2453	300	2940
39	60	120	1176	180	1764	220	2156	300	2943	370	3626
42	65	155	1519	240	2352	280	2744	390	3826	470	4606
45	70	180	1764	280	2744	320	3136	450	4415	550	5390
48	75	230	2254	350	3430	400	3920	570	5592	680	6664
52	80	280	2744	420	4116	480	4704	670	6573	850	8330
56	85	360	3528	530	5149	610	5978	860	8437	1050	10290
60	90	410	4018	610	5978	790	7742	1100	10791	1350	13230
64	95	510	4998	760	7448	900	8820				
68	100	580	5684	870	8526	1100	10780				
72	105	660	6468	1000	9800	1290	12642				
76	110	750	7350	1100	10780	1500	14701				
80	115	830	8143	1250	12250	18580	18130				
85	120	900	8820	1400	13720	2250	22050				
90	130	1080	10584	1650	16170	2500	24500				
100	145	1400	13720	2050	20090						
110	155	1670	16366	2550	24990						
120	175	2030	19894	3050	29890						

- This is Germany standard(DIN) above, the figure in the form is the max torque of the bolt, and the recommend torque is 80% of chart figure.
- The recommended tightening torque equals the figure in the form $\times(80\sim 90\%)$. For instance:M52, strength grade is 8.8 , the torque is $4704 \times 90\% = 4233.6\text{N. m}$
- It is recommended that loosening torque equals about 150% of tightening. For instance, the tightening torque is $4233.6 \times (1.5 \sim 2) = 6350.4 \sim 8467.2\text{N. m}$

The Sapce

Because of the sapce restriction, please notice the location, For example:

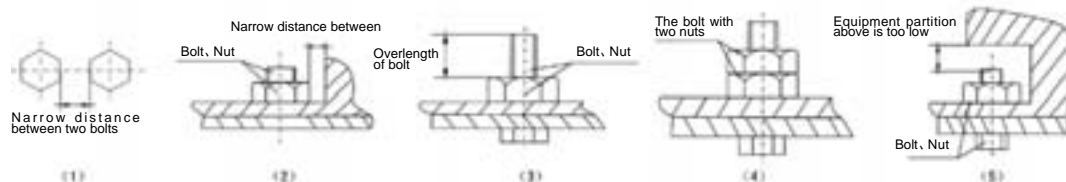

The conditions above, please use Low Profile Wrench instead of square drive type.

Torque Wrench Pump

Product Description

- Compact automatic three stage flow, max efficiency.
- Applicable on both one or two wrenches simultaneously.
- Aluminum oil tank with oil gauge and thermometer.
- $\Phi 100$ high pressure gauge.
- Working pressure: 40~700 bar
- With efficient radiator, the pump can work 24 hours continuously.
- The motor can be changed according to the different voltage.
- You can use manifold to operate 4 wrenches simultaneously.

Specifications

Drive	Electric
Tank capacity	8L
Flow (Low-Mid-High)	7~1.6~0.8 L/min
Output pressure	70~700 bar
Source of power	1.1KW
N.W(kg)	26.7

KLW4000



Product Description

- Suitable for air (4~8 Bar) is the preferred source of energy.
- Compact automatic three stage flow, can start in high pressure.
- Applicable on both one or two wrenches simultaneously. Aluminum oil tank with oil gauge and motor. Total weight is only 20.5kg.
- $\Phi 100$ high pressure gauge
- Working pressure: 40~700 bar
- With efficient radiator, the pump can work 24 hours continuously.
- You can use manifold to operate 4 wrenches simultaneously.

Specifications

Drive	Air
Tank capacity	8L
Flow (Low-Mid-High)	7~1.6~0.8 L/min
Output pressure	70~700 bar
Air in	4~8 bar
Source of power	1.1KW
N.W(kg)	20.5

KLW4000N



Hydraulic Torque Wrench and Tools

KLW4100

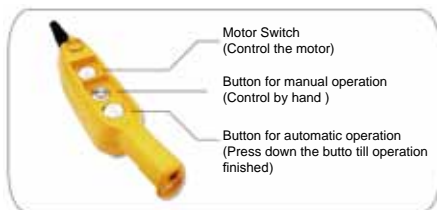

Product Description

• KLW4100 Series Automatic Electrical Pump shared a same design with KLW4000 series standard Electrical Pump, added a set of control system (import from Germany) on the basic of KLW4000 standard Pump, it inherited all the characteristics of KLW4000, some other characteristics of this Pump are as below:

• **Simple Operation:**

Operate with one Button, the operator just need to press down the button one time to achieve the operation of tightening and loosening.

• **High Efficiency:**

Compare with the general Pump, KLW4100 Automatic Pump has compact operation process to reduce some needless action and increase approximate 50% of working efficiency.

• **Manual / Automatic**

Besides of the automatic operation, the Pump also has the function of manual operation, for some special operation, KLW4100 also can be worked well.

Additionally the KLW4100 can work 24 hours without stop with radiator, We can also make the Pump with other kinds of motors according customers' requirements

Specifications

Drive	Electric
Tank capacity	8L
Flow (Low-Mid-High)	7~1.6~0.8 L/min
Output pressure	70~700 bar
Source of power	1.1KW
N.W(kg)	26.7

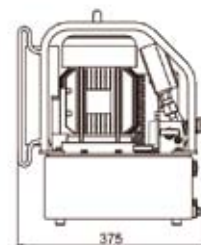
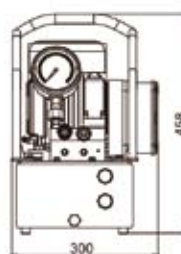
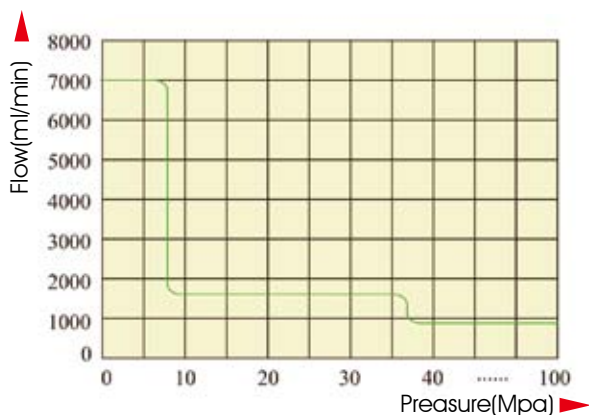

FP-4 (Optional)



Hydraulic Nut Splitters



Product Description

- Compact and ergonomic design, easy to use
- Unique angled head design
- Single-acting, spring return cylinder
- Heavy duty chisels can be reground
- Nut Splitters include spare chisel, spare set screw and wrench used to secure the chisel.
- Applications include service trucks, piping industry, tank cleaning, petrochemical, steel construction, mining, etc.

Specifications

- Hexagon Nut Range: 10-75mm
- Bolt Range: M6-M48
- Maximum Operating Pressure: 700bar

Ordering Information

Model No.	Bolt Range(mm)	Hexagon Nut Range(mm)	Capacity Ton (kN)	Length (mm)	Width (mm)	Height (mm)	Oil Capacity(cm ³)	N.W(kg)
HYNC-1319	M6- M12	10- 19	5 (49)	170	40	48	15	1.2
HYNC-1942	M12- M16	19- 24	10 (98)	191	54	62	20	2.0
HYNC-2432	M16- M22	24- 32	15 (147)	222	64	72	60	3.0
HYNC-3241	M22- M27	32- 41	20 (196)	224	75	88	80	4.4
HYNC-4150	M27- M33	41- 50	35 (343)	288	94	105	155	8.2
HYNC-5060	M33- M39	50- 60	50 (490)	318	106	128	240	11.8
HYNC-6075	M39- M48	60- 75	90 (882)	393	156	181	492	34.1

Max. allowable material hardness to split is HRc-44. Not to be used on square nuts

MP Series Electric Pumps

Product Description

- Double-speed designed, infinitely variable pressure adjustment between 0-700 bar.
- Modularity product, supply more than 200 kinds electric pump, and 5 different valves are available, 4-56L multiple oil tank, and many different electrical motor(100-120V, 200-240V, 350-420V).
- MP-series electric hydraulic pumps suits to a wide variety of industrial and application fields to work as lifting, pushing, pulling, bending, pressing, punching and many other applications. It is a economical and durable power source.



Ordering Information

Valve Block		Introduction To Basic Functions	Circuit Diagram
Type A: Manual Valve (double-acting)		By the manual valve to operate the double acting tank, responses quickly, and the reservoir piston will stop at once and keep the pressure for a long period.	
Type B: Manual Valve (single-acting)		By the manual valve to operate the single acting tank, responses quickly, easy control, keep the pressure for a long period.	
Type C: Solenoid Valve (single-acting)		By the solenoid valve to operate the single acting tank, responses quickly, easy control, keep the pressure for a long period.	
Type D: Solenoid Valve (single-acting)		Press a button to operate the solenoid valve to control the outputting and inputting oil of the oil pump.	
Type H: Solenoid Valve (double-acting)		By the solenoid valve to operate the double acting tank, responses quickly, and the reservoir piston will stop at once and keep the pressure for a long period.	

Above the valve block can be installed in any size of oil tank

Hydraulic Torque Wrench and Tools

MP Series Pump Selection Table

220~230V/50Hz				Universal specifications				220~230V/60Hz					
Model No.	Power	Flow L/min		Valve type	Valve function	Volume	N.W	Flow L/min		Power	Model No.		
		Low	High					Low	High				
MP04AR56	0.37KW Single Phase	2	0.3	TypeA:Manual Valve(duble-acting)	Input/Lock/Output	6L/4L	19						
MP04BR56		2	0.3	TypeB:Manual Valve(single-acting)	Input/Output		19						
MP04CR56		2	0.3	TypeC:Solenoid Valve(single-acting)	Input/Lock/Output		19						
MP04DR56		2	0.3	TypeD:Solenoid Valve(single-acting)	Input/Output		19						
MP04HR56		2	0.3	TypeH:Solenoid Valve(duble-acting)	Input/Lock/Output		19						
MP08AS12	1.0KW Single Phase	5.5	0.6	TypeA:Manual Valve(duble-acting)	Input/Lock/Output	10L/8L	21.5	4.5	0.7		MP08AT23		
MP08BS12		5.5	0.6	TypeB:Manual Valve(single-acting)	Input/Output		21.5	4.5	0.7		MP08BT23		
MP08CS12		5.5	0.6	TypeC:Solenoid Valve(single-acting)	Input/Lock/Output		21.5	4.5	0.7		MP08CT23		
MP08DS12		5.5	0.6	TypeD:Solenoid Valve(single-acting)	Input/Output		21.5	4.5	0.7		MP08DT23		
MP08HS12		5.5	0.6	TypeH:Solenoid Valve(duble-acting)	Input/Lock/Output		21.5	4.5	0.7		MP08HT23		
MP13AT13	1.1KW Single Phase	5.5	0.8	TypeA:Manual Valve(duble-acting)	Input/Lock/Output	17L/13L	26	4.5	0.7		MP13AT23		
MP13BT13		7.2	0.8	TypeB:Manual Valve(single-acting)	Input/Output		26	4.5	0.7		MP13BT23		
MP13CT13		7.2	0.8	TypeC:Solenoid Valve(single-acting)	Input/Lock/Output		26	4.5	0.7		MP13CT23		
MP13DT13		7.2	0.8	TypeD:Solenoid Valve(single-acting)	Input/Output	26	4.5	0.7	MP13DT23				
MP13HT13		5.5	0.8	TypeH:Solenoid Valve(duble-acting)	Input/Lock/Output	26	4.5	0.7	MP13HT23				
MP18AT13		5.5	0.8	TypeA:Manual Valve(duble-acting)	Input/Lock/Output	20L/18L	27	4.5	0.7		MP18AT23		
MP18BT13		7.2	0.8	TypeB:Manual Valve(single-acting)	Input/Output		27	4.5	0.7		MP18BT23		
MP18CT13		7.2	0.8	TypeC:Solenoid Valve(single-acting)	Input/Lock/Output		27	4.5	0.7		MP18CT23		
MP18DT13		7.2	0.8	TypeD:Solenoid Valve(single-acting)	Input/Output	27	4.5	0.7	MP18DT23				
MP18HT13		5.5	0.8	TypeH:Solenoid Valve(duble-acting)	Input/Lock/Output	27	4.5	0.7	MP18HT23				
MP24AT13		1.1KW Single Phase	5.5	0.8	TypeA:Manual Valve(duble-acting)	Input/Lock/Output	27L/24L	29	4.5		0.7		MP24AT23
MP24BT13			7.2	0.8	TypeB:Manual Valve(single-acting)	Input/Output		29	4.5		0.7		MP24BT23
MP24CT13			7.2	0.8	TypeC:Solenoid Valve(single-acting)	Input/Lock/Output		29	4.5		0.7		MP24CT23
MP24DT13			7.2	0.8	TypeD:Solenoid Valve(single-acting)	Input/Output	29	4.5	0.7		MP24DT23		
MP24HT13			5.5	0.8	TypeH:Solenoid Valve(duble-acting)	Input/Lock/Output	29	4.5	0.7		MP24HT23		
MP32AT13	5.5		0.8	TypeA:Manual Valve(duble-acting)	Input/Lock/Output	40L/32L	33	4.5	0.7	MP32AT23			
MP32BT13	7.2		0.8	TypeB:Manual Valve(single-acting)	Input/Output		33	4.5	0.7	MP32BT23			
MP32CT13	7.2		0.8	TypeC:Solenoid Valve(single-acting)	Input/Lock/Output		33	4.5	0.7	MP32CT23			
MP32DT13	7.2		0.8	TypeD:Solenoid Valve(single-acting)	Input/Output	33	4.5	0.7	MP32DT23				
MP32HT13	5.5		0.8	TypeH:Solenoid Valve(duble-acting)	Input/Lock/Output	33	4.5	0.7	MP32HT23				
MP56AT13	1.1KW Three Phase		5.5	0.8	TypeA:Manual Valve(duble-acting)	Input/Lock/Output	64L/56L	37	4.5	0.7			MP56AT23
MP56BT13			7.2	0.8	TypeB:Manual Valve(single-acting)	Input/Output		37	4.5	0.7			MP56BT23
MP56CT13			7.2	0.8	TypeC:Solenoid Valve(single-acting)	Input/Lock/Output		37	4.5	0.7			MP56CT23
MP56DT13			7.2	0.8	TypeD:Solenoid Valve(single-acting)	Input/Output		37	4.5	0.7			MP56DT23
MP56HT13			5.5	0.8	TypeH:Solenoid Valve(duble-acting)	Input/Lock/Output		37	4.5	0.7			MP56HT23
350~420V/50Hz				Universal specifications				350~420V/60Hz					
MP08AT63	1.1KW Three Phase	5.5	0.8	TypeA:Manual Valve(duble-acting)	Input/Lock/Output	10L/8L	25	4.5	0.7		MP08AT83		
MP08BT63		7.2	0.8	TypeB:Manual Valve(single-acting)	Input/Output		25	4.5	0.7		MP08BT83		
MP08CT63		7.2	0.8	TypeC:Solenoid Valve(single-acting)	Input/Lock/Output		25	4.5	0.7		MP08CT83		
MP08DT63		7.2	0.8	TypeD:Solenoid Valve(single-acting)	Input/Output		25	4.5	0.7		MP08DT83		
MP08HT63		5.5	0.8	TypeH:Solenoid Valve(duble-acting)	Input/Lock/Output		25	4.5	0.7		MP08HT83		
MP13AT63		5.5	0.8	TypeA:Manual Valve(duble-acting)	Input/Lock/Output	17L/13L	26	4.5	0.7		MP13AT83		
MP13BT63		7.2	0.8	TypeB:Manual Valve(single-acting)	Input/Output		26	4.5	0.7		MP13BT83		
MP13CT63		7.2	0.8	TypeC:Solenoid Valve(single-acting)	Input/Lock/Output		26	4.5	0.7		MP13CT83		
MP13DT63		7.2	0.8	TypeD:Solenoid Valve(single-acting)	Input/Output	26	4.5	0.7	MP13DT83				
MP13HT63		5.5	0.8	TypeH:Solenoid Valve(duble-acting)	Input/Lock/Output	26	4.5	0.7	MP13HT83				
MP18AT63		5.5	0.8	TypeA:Manual Valve(duble-acting)	Input/Lock/Output	20L/18L	27	4.5	0.7		MP18AT83		
MP18BT63		7.2	0.8	TypeB:Manual Valve(single-acting)	Input/Output		27	4.5	0.7		MP18BT83		
MP18CT63		7.2	0.8	TypeC:Solenoid Valve(single-acting)	Input/Lock/Output		27	4.5	0.7		MP18CT83		
MP18DT63		7.2	0.8	TypeD:Solenoid Valve(single-acting)	Input/Output	27	4.5	0.7	MP18DT83				
MP18HT63		5.5	0.8	TypeH:Solenoid Valve(duble-acting)	Input/Lock/Output	27	4.5	0.7	MP18HT83				
MP24AT63	5.5	0.8	TypeA:Manual Valve(duble-acting)	Input/Lock/Output	27L/24L	29	4.5	0.7	MP24AT83				
MP24BT63	7.2	0.8	TypeB:Manual Valve(single-acting)	Input/Output		29	4.5	0.7	MP24BT83				
MP24CT63	7.2	0.8	TypeC:Solenoid Valve(single-acting)	Input/Lock/Output		29	4.5	0.7	MP24CT83				
MP24DT63	7.2	0.8	TypeD:Solenoid Valve(single-acting)	Input/Output	29	4.5	0.7	MP24DT83					
MP24HT63	5.5	0.8	TypeH:Solenoid Valve(duble-acting)	Input/Lock/Output	29	4.5	0.7	MP24HT83					
MP32AT63	5.5	0.8	TypeA:Manual Valve(duble-acting)	Input/Lock/Output	40/32L	33	4.5	0.7	MP32AT83				
MP32BT63	7.2	0.8	TypeB:Manual Valve(single-acting)	Input/Output		33	4.5	0.7	MP32BT83				
MP32CT63	7.2	0.8	TypeC:Solenoid Valve(single-acting)	Input/Lock/Output		33	4.5	0.7	MP32CT83				
MP32DT63	7.2	0.8	TypeD:Solenoid Valve(single-acting)	Input/Output	33	4.5	0.7	MP32DT83					
MP32HT63	5.5	0.8	TypeH:Solenoid Valve(duble-acting)	Input/Lock/Output	33	4.5	0.7	MP32HT83					
MP56AT63	5.5	0.8	TypeA:Manual Valve(duble-acting)	Input/Lock/Output	64L/56L	37	4.5	0.7	MP56AT83				
MP56BT63	7.2	0.8	TypeB:Manual Valve(single-acting)	Input/Output		37	4.5	0.7	MP56BT83				
MP56CT63	7.2	0.8	TypeC:Solenoid Valve(single-acting)	Input/Lock/Output		37	4.5	0.7	MP56CT83				
MP56DT63	7.2	0.8	TypeD:Solenoid Valve(single-acting)	Input/Output		37	4.5	0.7	MP56DT83				
MP56HT63	5.5	0.8	TypeH:Solenoid Valve(duble-acting)	Input/Lock/Output		37	4.5	0.7	MP56HT83				

Hydraulic Torque Wrench and Tools

MP Series Pump Selection Table

100~120V/50Hz				Universal specifications				100~120V/60Hz			
Model No.	Power	Flow L/min		Valve type	Valve function	Volume	N.W	Flow L/min		Power	Model No.
		Low	High					Low	High		
MP08AT33	1.1KW Single Phase	5.5	0.8	TypeA:Manual Valve(duble-acting)	Input/Lock/Output	10L/8L	25	4.5	0.7	0.9KW Single Phase	MP08AT43
MP08BT33		7.2	0.8	TypeB:Manual Valve(single-acting)	Input/Output		25	4.5	0.7		MP08BT43
MP08CT33		7.2	0.8	TypeC:Solenoid Valve(single-acting)	Input/Lock/Output		25	4.5	0.7		MP08CT43
MP08DT33		7.2	0.8	TypeD:Solenoid Valve(single-acting)	Input/Output		25	4.5	0.7		MP08DT43
MP08HT33		5.5	0.8	TypeH:Solenoid Valve(duble-acting)	Input/Lock/Output	25	4.5	0.7	MP08HT43		
MP13AT33		5.5	0.8	TypeA:Manual Valve(duble-acting)	Input/Lock/Output	17L/13L	26	4.5	0.7		MP13AT43
MP13BT33		7.2	0.8	TypeB:Manual Valve(single-acting)	Input/Output		26	4.5	0.7		MP13BT43
MP13CT33		7.2	0.8	TypeC:Solenoid Valve(single-acting)	Input/Lock/Output		26	4.5	0.7		MP13CT43
MP13DT33		7.2	0.8	TypeD:Solenoid Valve(single-acting)	Input/Output		26	4.5	0.7		MP13DT43
MP13HT33		5.5	0.8	TypeH:Solenoid Valve(duble-acting)	Input/Lock/Output	26	4.5	0.7	MP13HT43		
MP18AT33		5.5	0.8	TypeA:Manual Valve(duble-acting)	Input/Lock/Output	20L/18L	27	4.5	0.7		MP18AT43
MP18BT33		7.2	0.8	TypeB:Manual Valve(single-acting)	Input/Output		27	4.5	0.7		MP18BT43
MP18CT33		7.2	0.8	TypeC:Solenoid Valve(single-acting)	Input/Lock/Output		27	4.5	0.7		MP18CT43
MP18DT33		7.2	0.8	TypeD:Solenoid Valve(single-acting)	Input/Output		27	4.5	0.7		MP18DT43
MP18HT33		5.5	0.8	TypeH:Solenoid Valve(duble-acting)	Input/Lock/Output	27	4.5	0.7	MP18HT43		
MP24AT33		5.5	0.8	TypeA:Manual Valve(duble-acting)	Input/Lock/Output	27L/24L	29	4.5	0.7		MP24AT43
MP24BT33		7.2	0.8	TypeB:Manual Valve(single-acting)	Input/Output		29	4.5	0.7		MP24BT43
MP24CT33		7.2	0.8	TypeC:Solenoid Valve(single-acting)	Input/Lock/Output		29	4.5	0.7		MP24CT43
MP24DT33		7.2	0.8	TypeD:Solenoid Valve(single-acting)	Input/Output		29	4.5	0.7		MP24DT43
MP24HT33		5.5	0.8	TypeH:Solenoid Valve(duble-acting)	Input/Lock/Output	29	4.5	0.7	MP24HT43		
MP32AT33		5.5	0.8	TypeA:Manual Valve(duble-acting)	Input/Lock/Output	40L/32L	33	4.5	0.7		MP32AT43
MP32BT33		7.2	0.8	TypeB:Manual Valve(single-acting)	Input/Output		33	4.5	0.7		MP32BT43
MP32CT33		7.2	0.8	TypeC:Solenoid Valve(single-acting)	Input/Lock/Output		33	4.5	0.7		MP32CT43
MP32DT33		7.2	0.8	TypeD:Solenoid Valve(single-acting)	Input/Output		33	4.5	0.7		MP32DT43
MP32HT33		5.5	0.8	TypeH:Solenoid Valve(duble-acting)	Input/Lock/Output	33	4.5	0.7	MP32HT43		
MP56AT33		5.5	0.8	TypeA:Manual Valve(duble-acting)	Input/Lock/Output	64L/56L	37	4.5	0.7		MP56AT43
MP56BT33		7.2	0.8	TypeB:Manual Valve(single-acting)	Input/Output		37	4.5	0.7		MP56BT43
MP56CT33		7.2	0.8	TypeC:Solenoid Valve(single-acting)	Input/Lock/Output		37	4.5	0.7		MP56CT43
MP56DT33		7.2	0.8	TypeD:Solenoid Valve(single-acting)	Input/Output		37	4.5	0.7		MP56DT43
MP56HT33		5.5	0.8	TypeH:Solenoid Valve(duble-acting)	Input/Lock/Output	37	4.5	0.7	MP56HT43		
200~240V/50Hz				Universal specifications				200~240V/60Hz			
MP08AT73	1.1KW Three Phase	5.5	0.8	TypeA:Manual Valve(duble-acting)	Input/Lock/Output	10L/8L	25	4.5	0.7	1.1KW Three Phase	MP08AT93
MP08BT73		7.2	0.8	TypeB:Manual Valve(single-acting)	Input/Output		25	4.5	0.7		MP08BT93
MP08CT73		7.2	0.8	TypeC:Solenoid Valve(single-acting)	Input/Lock/Output		25	4.5	0.7		MP08CT93
MP08DT73		7.2	0.8	TypeD:Solenoid Valve(single-acting)	Input/Output		25	4.5	0.7		MP08DT93
MP08HT73		5.5	0.8	TypeH:Solenoid Valve(duble-acting)	Input/Lock/Output	25	4.5	0.7	MP08HT93		
MP13AT73		5.5	0.8	TypeA:Manual Valve(duble-acting)	Input/Lock/Output	17L/13L	26	4.5	0.7		MP13AT93
MP13BT73		7.2	0.8	TypeB:Manual Valve(single-acting)	Input/Output		26	4.5	0.7		MP13BT93
MP13CT73		7.2	0.8	TypeC:Solenoid Valve(single-acting)	Input/Lock/Output		26	4.5	0.7		MP13CT93
MP13DT73		7.2	0.8	TypeD:Solenoid Valve(single-acting)	Input/Output		26	4.5	0.7		MP13DT93
MP13HT73		5.5	0.8	TypeH:Solenoid Valve(duble-acting)	Input/Lock/Output	26	4.5	0.7	MP13HT93		
MP18AT73		5.5	0.8	TypeA:Manual Valve(duble-acting)	Input/Lock/Output	20L/18L	27	4.5	0.7		MP18AT93
MP18BT73		7.2	0.8	TypeB:Manual Valve(single-acting)	Input/Output		27	4.5	0.7		MP18BT93
MP18CT73		7.2	0.8	TypeC:Solenoid Valve(single-acting)	Input/Lock/Output		27	4.5	0.7		MP18CT93
MP18DT73		7.2	0.8	TypeD:Solenoid Valve(single-acting)	Input/Output		27	4.5	0.7		MP18DT93
MP18HT73		5.5	0.8	TypeH:Solenoid Valve(duble-acting)	Input/Lock/Output	27	4.5	0.7	MP18HT93		
MP24AT73		5.5	0.8	TypeA:Manual Valve(duble-acting)	Input/Lock/Output	27L/24L	29	4.5	0.7		MP24AT93
MP24BT73		7.2	0.8	TypeB:Manual Valve(single-acting)	Input/Output		29	4.5	0.7		MP24BT93
MP24CT73		7.2	0.8	TypeC:Solenoid Valve(single-acting)	Input/Lock/Output		29	4.5	0.7		MP24CT93
MP24DT73		7.2	0.8	TypeD:Solenoid Valve(single-acting)	Input/Output		29	4.5	0.7		MP24DT93
MP24HT73		5.5	0.8	TypeH:Solenoid Valve(duble-acting)	Input/Lock/Output	29	4.5	0.7	MP24HT93		
MP32AT73		5.5	0.8	TypeA:Manual Valve(duble-acting)	Input/Lock/Output	40/32L	33	4.5	0.7		MP32AT93
MP32BT73		7.2	0.8	TypeB:Manual Valve(single-acting)	Input/Output		33	4.5	0.7		MP32BT93
MP32CT73		7.2	0.8	TypeC:Solenoid Valve(single-acting)	Input/Lock/Output		33	4.5	0.7		MP32CT93
MP32DT73		7.2	0.8	TypeD:Solenoid Valve(single-acting)	Input/Output		33	4.5	0.7		MP32DT93
MP32HT73		5.5	0.8	TypeH:Solenoid Valve(duble-acting)	Input/Lock/Output	33	4.5	0.7	MP32HT93		
MP56AT73		5.5	0.8	TypeA:Manual Valve(duble-acting)	Input/Lock/Output	64L/56L	37	4.5	0.7		MP56AT93
MP56BT73		7.2	0.8	TypeB:Manual Valve(single-acting)	Input/Output		37	4.5	0.7		MP56BT93
MP56CT73		7.2	0.8	TypeC:Solenoid Valve(single-acting)	Input/Lock/Output		37	4.5	0.7		MP56CT93
MP56DT73		7.2	0.8	TypeD:Solenoid Valve(single-acting)	Input/Output		37	4.5	0.7		MP56DT93
MP56HT73		5.5	0.8	TypeH:Solenoid Valve(duble-acting)	Input/Lock/Output	37	4.5	0.7	MP56HT93		

Hydraulic Torque Wrench and Tools

Outline Dimension Drawing of MP Series Pump

MP04 series

6L tank and 4L available, use 0.37KW power and type A/B/C valve

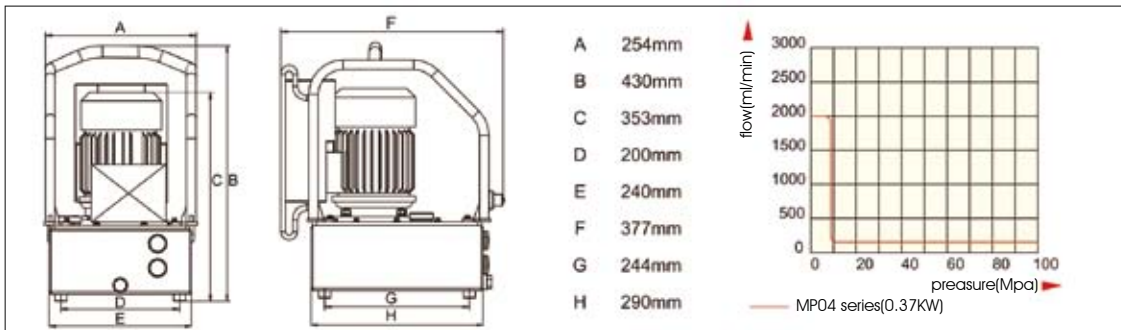

MP08 series

10L tank and 8L available, use 0.37KW&1.1KW power and type A/B/C/D/H valve

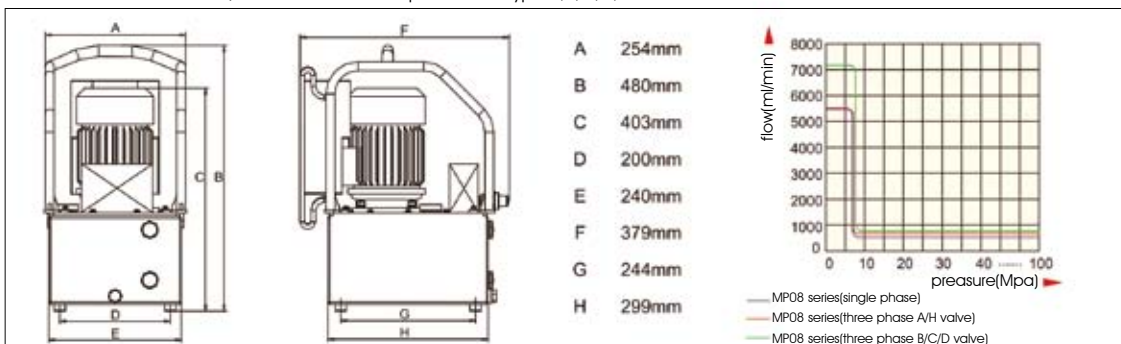

MP13 series

17L tank and 13L available, use 1.1KW power and type A/B/C/D/H valve

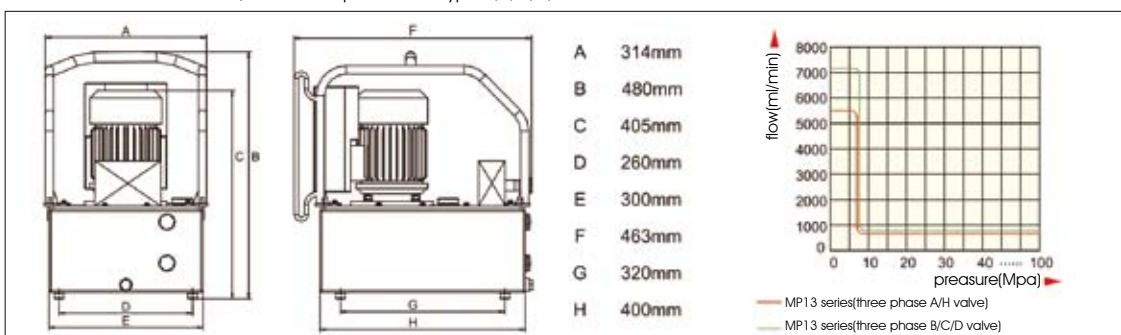

MP18 series

20L tank and 18L available, use 1.1KW power and type A/B/C/D/H valve

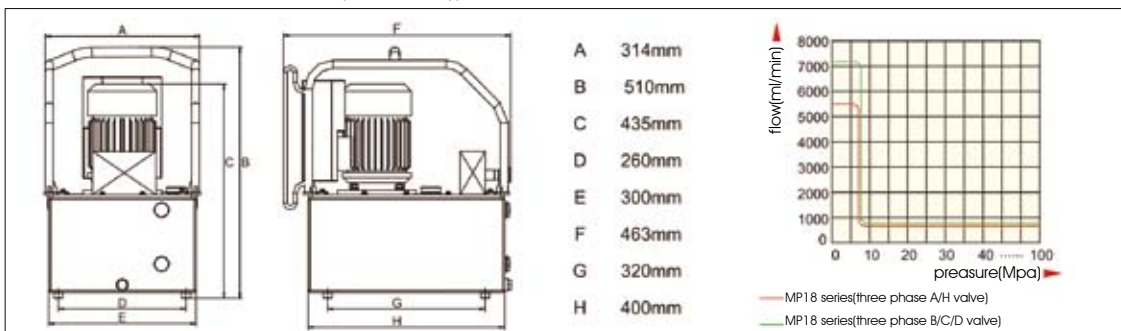

Hydraulic Torque Wrench and Tools

MP24 series
27L tank and 24L available, use 1.1KW power and type A/B/C/D/H valve

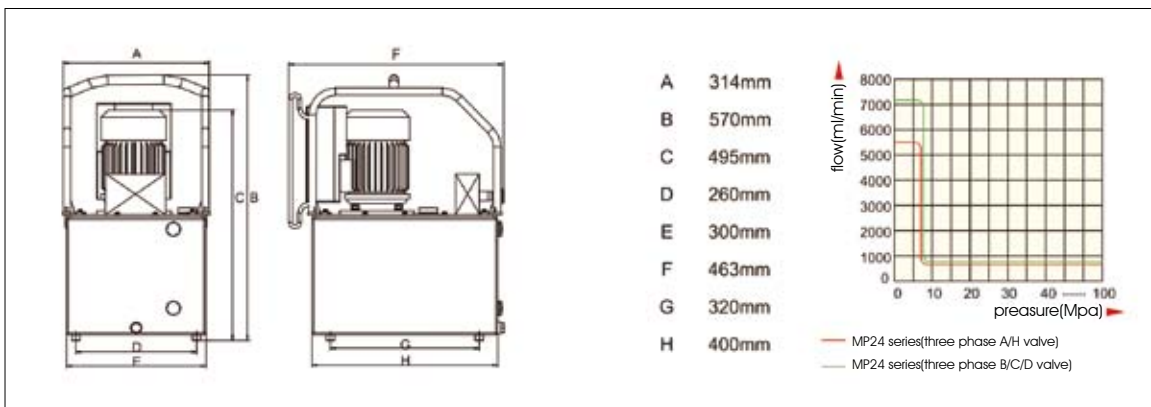

MP32 series
40L tank and 32L available, use 1.1KW power and type A/B/C/D/H valve

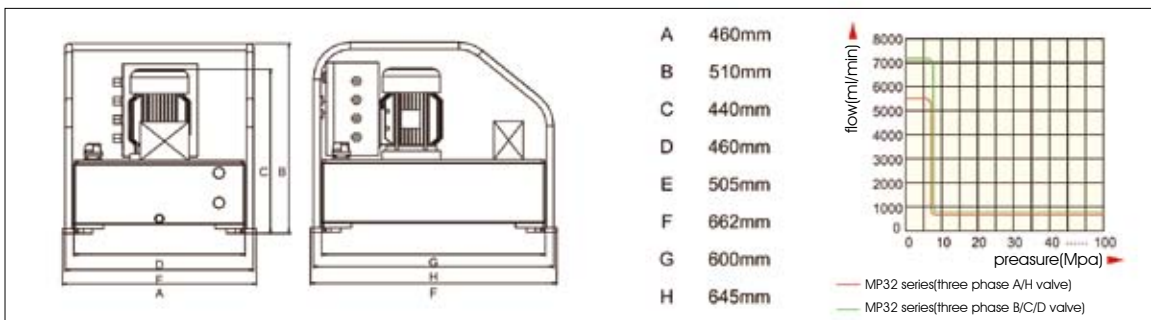

MP56 series
64L tank and 32L available, use 1.1KW power and type A/B/C/D/H valve

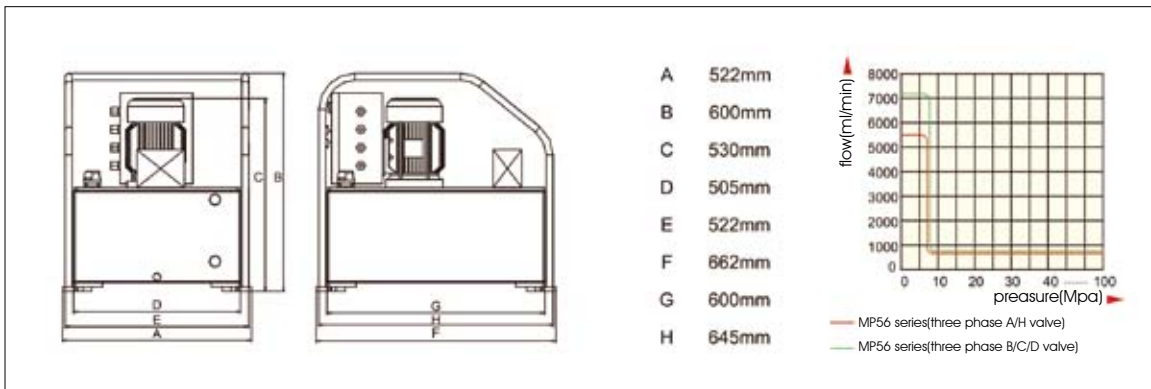

These are all the standard configuration, if you have some special requirements, please contact us, We will provide our best serving for all the customers.

Examples of System Connection for Hydraulic Wrench

Conditions

- The existing M42(S65) strength grade lever 8.8 flange bolt with a two drive type hydraulic torque wrench
- Each type of hydraulic torque wrench has its own torque range.
- If known locking torque value is X N. m, the wrench maximum output torque value should be at least 2X N. m (the loosening torque is 1.5~2 times than locking). For the bolt M42(S65) bolt in this demonstration, If the technical requirements of the locking torque values is 2600N. m, it is suggested that the torque value should be greater than 5200N. m. (If there are no loosening requirements in the filed conditions, relatively little torque models can be used). According to selection table, the most suitable wrench is model 5IBT.
- If the locking torque requirements is not clear. Our engineer can recommend the suitable model. You can also follow the steps below to choose suitable models according to the chart of bolt and nut torque value. In current case, the M42(S65) bolt locking torque is $2744 \times 90\% = 2470\text{N. m}$. The loosening torque is 1.5~2 times greater than locking, so the matching hydraulic wrench torque value should be greater than 4940N. m. After checking selection chart, the most suitable torque wrench wrench is model 5IBT.

Demonstration

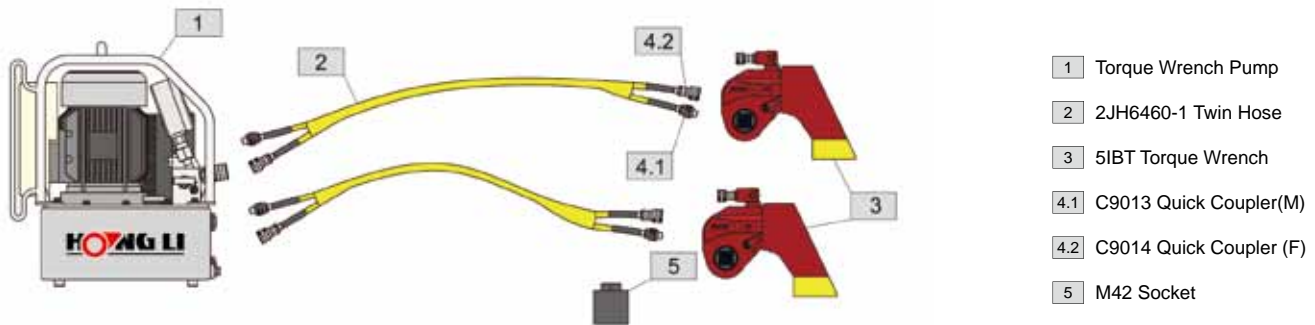

One pump with two torque wrenches

Type	Quantity	Description
LP3	1	220V/50Hz Output 70Mpa
5IBT	2	Torque 752~7528N. m
2JH6460-1	2	6M
C901 Quick Coupler	4	C9013 and C9014 for a pair
M42 Socket	2	1-1/2" to S65

One with One

Type	Quantity	Description
LP3	1	220V/50Hz Output 70Mpa
5IBT	1	Torque 752~7528N. m
2JH6460-1	1	6M
C901 Quick Coupler	2	C9013 and C9014 for a pair
M42 Socket	1	1-1/2" to S65